

Disc brakes

Technical data and dimensions

Calipers 45K and 45D

Fail safe braking
 Spring application
 Electromagnetic release
 Automatic linings wear compensation
 Opening proving switch
 Coil with supply wire: 2 × 2mm², length 2m
 Association with 30mm thick discs (or 15mm in option)
 Shoes DIN (caliper 45D) for discs thickness 30mm only.

Conditions of use :
 • Ambient temperature -20°C to + 60°C
 • Relative humidity ≤ 70 %
 • Dust in atmosphere ≥ 65 μ
 Other conditions, consult us.

Use:
 • Service brake for application ≤ 600 cycles / h
 Possibility of quick manoeuvres :
 1000 cycles/h during 15s every 2 mn

Options:
 • Lowering system with lever
 • Hydraulic lowering system
 • Manual wear compensation (RM)
 • Marine protection
 • SIDHT steel industry high temperature
 • Bearing brackets for mounting in place of a caliper 645.
 • Mounting on a vertical axis disc.
 • Closing proving switch
 • Manual release switch

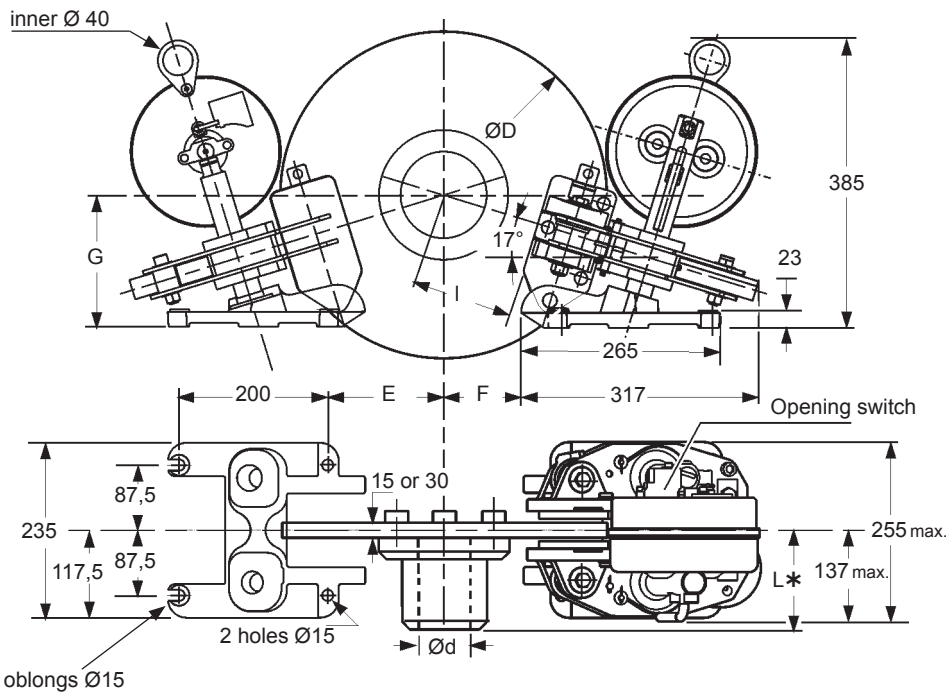

Nota :
 The 45K-RM and 45D-RM calipers (manual wear compensation option) have the same overall dimensions as the 45K and 45D calipers with automatic wear compensation.

*** ATTENTION**
 For discs Ø315 to 395, the length of 137 max. is higher than the length L of the standard hub. Provide space at the rear of the hub by means of a spacer.

Opening proving switch :
 250VAC maxi., 5A maxi., with interrupting capacity: 50VA maxi.
 220VDC maxi., 5A maxi., with interrupting capacity: 50W maxi.

Compatible with PLC (Programmable Logic Controllers).
 An opening switch used with other equipment than PLC must not be reused with a PLC.

Weight : 41kg
 Response time at nominal torque : see the leaflet of the associated electrical power supply.
 Caliper delivered in standard with WS1-5 lining.
 For energy applications, use WS1-3 (torque loss of 20%).

Designation	Discs	solid and thickness 15 mm (option)							ventilated and thickness 30 mm						
		315	355	395	445	495	550	625	315	355	395	445	495	550	625
D Disc diameter	mm	315	355	395	445	495	550	625	315	355	395	445	495	550	625
Nominal torque for 1 caliper adjustable from -30% to +20%	N.m	410	470	560	650	750	840	990	410	470	560	650	750	840	990
Maximum speed of the disc for nominal torque	tr/mn	3000	2700	2400	2100	1900	1800	1500	3000	2700	2400	2100	1900	1800	1500
d	mm	0-75	0-75	0-75	0-75	0-100	0-100	0-100	0-50	0-60	0-70	0-70	0-100	0-100	0-100
E	mm	100	120	140	160	190	220	255	100	120	140	160	190	220	255
F	mm	50	70	90	110	140	170	205	50	70	90	110	140	170	205
G	mm	160	164	170	180	185	195	205	160	164	170	180	185	195	205
l (calipers 45K, 45K-RM)	mm	75	95	116	138	168	200	236	75	95	116	138	168	200	236
l (caliper 45D)	mm								75	95	116	138	168	200	236
l (caliper 45D-RM)	mm								96	116	137	159	189	221	257
Maximum reaction on shaft	1 Caliper	N							4200						
	2 Calipers	N							2450						

Due to continuous development and improvement, all dimensions and characteristics are subject to change without notice.

Installation and maintenance	Leaflet No. M00140-01	Drawings	No. G06400-01	10/04/18
Spare parts	No. S00140-01	Electrical power unit 12514	No. T04210-01	
Options	No. A00140-01	Electrical power units AC64	No. T04500-01, T04510-01, T04560-01	
Discs	No. T02100-01 / T02220-01			T00140-01-J